

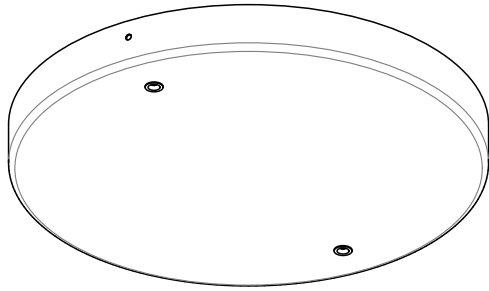

Gala Chandelier Canopy

15743 rB



CAUTION:

Before starting, turn off power
at main circuit panel.

ADVERTENCIA:

Antes de comenzar la instalación,
apague la corriente en el tablero
principal.

ATTENTION:

Coupez l'alimentation avant de
procéder à l'installation.



Calling for backup? Scan above
to contact our team.

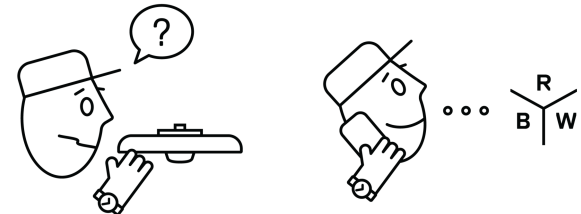

www.RBW.com
+1 212 388 0399
support@RBW.com
© 2023, RBW Studio LLC

What's Included: Part Configurations May Vary

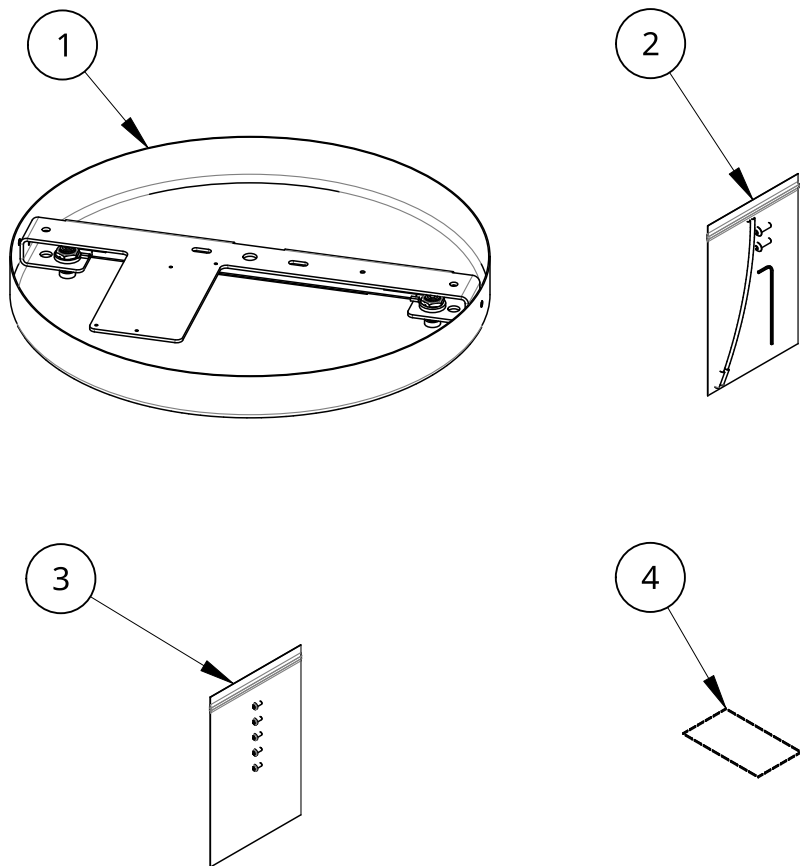

Item	Qty	Description
1	1	Gala Canopy Assembly Black
2	1	Gala Canopy Mounting Kit
3	1	Gala Driver Mounting Screw Kit
4	1	LED Driver

Canopy for 72" Boom must use 600mA Driver

Canopy for 42" Boom must use 400mA Driver

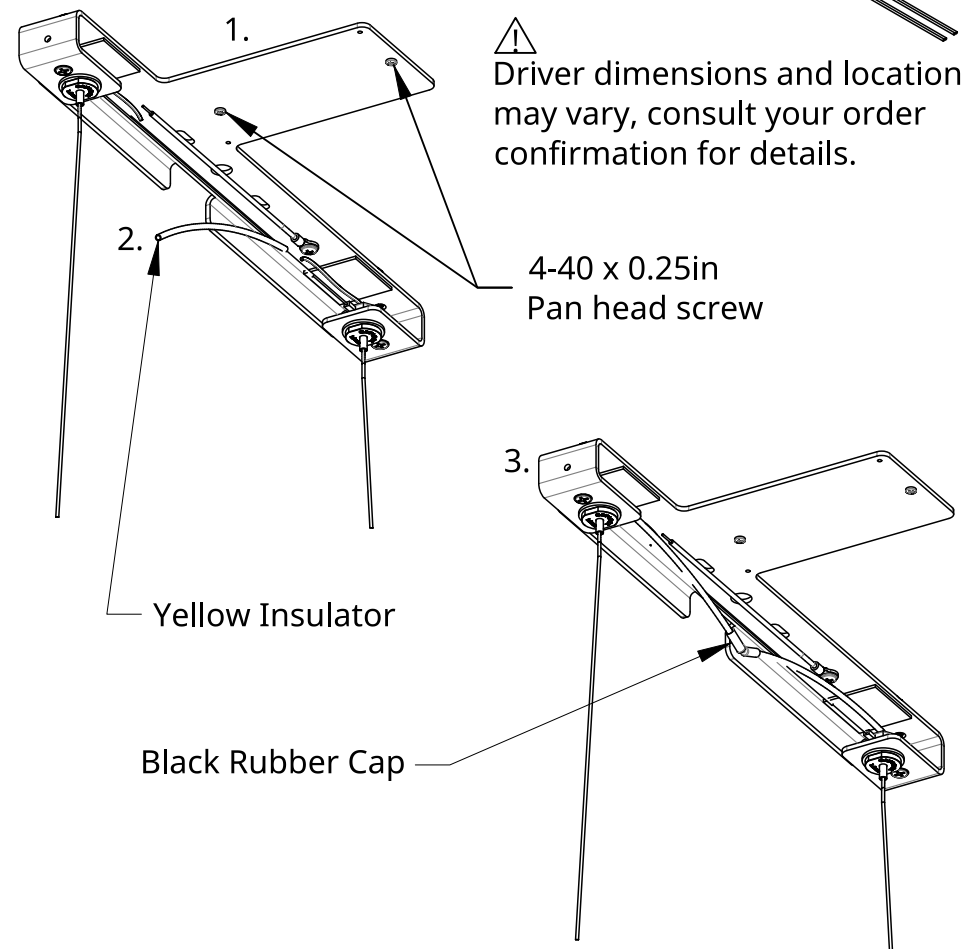

Installation - Driver and Powered Cables

1. Fasten driver to Crossbar via included 4-40 x 0.25in pan head screws.
2. Adjust fixture to final hang height. Trim excess Cables, slide Yellow Insulators over Cables.
3. Cap Yellow Insulators with Black Rubber Caps.

See chandelier installation instructions for mounting crossbar to substrate.

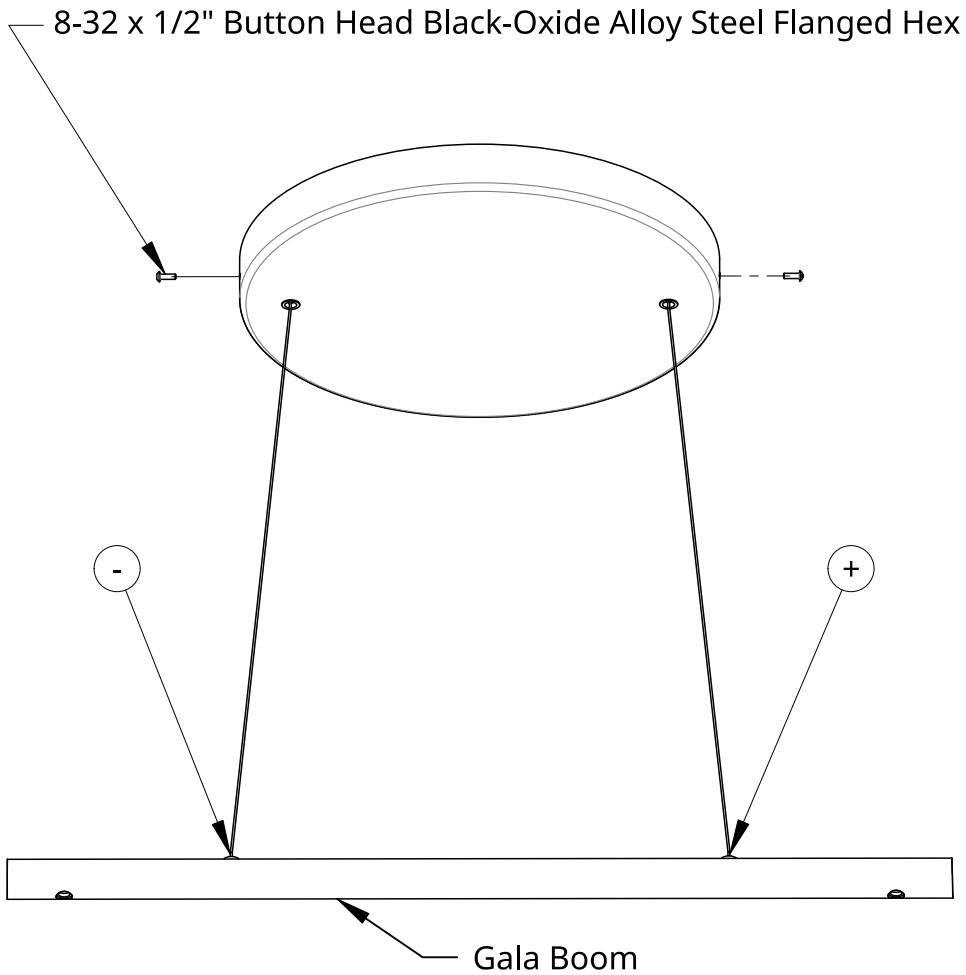

Page Intentionally Left Blank

Installation - Wiring and Canopy Screws

1. Connect Red (+) and Black (-) leads from driver to red and black leads connected to cable grippers.
2. Connect AC (L) and AC (N) leads from driver to leads in j-box.
3. Connect ground wire from canopy to ground in j-box
4. Slide Canopy upward and cover Crossbar. Secure in place with (2) 8-32 hex screws on either side of Canopy with provided allen key.
5. Congratulations! End of guide.